

# WEATHER DEFENDER

PREMIUM GARAGE DOOR SEALS

Please read the following and then select the section that applies to your particular Garage Door prior to commencing the installation of your floor seal. The fitting instructions are intended as a guide and you may decide after reading them to fit the floor seal in accordance with your own ideas.

The Weather Defender is a versatile Garage Door Floor Seal that can be fitted to Up and Over, Sectional, Roller Shutter and Side Hinged Garage Doors, whether they be Manual or Automatic.

① When fitted to Automatic Doors, there is a slight chance on some installations that the down limit and or sensitivity settings may need adjusting if the door auto reverses when closing onto the floor seal. If this is so please consult your owner's handbook or local dealer.

## RECOMMENDED INSTALLATION IMPLEMENTS



For the best results we recommend that the ground is in clean, sound condition and free from dust, oil, or grease.

You should abrade painted surfaces to ensure good adhesion.

## A INSTALLATION BETWEEN THE FRAME

For INSTALLATION BEHIND THE FRAME please see reverse

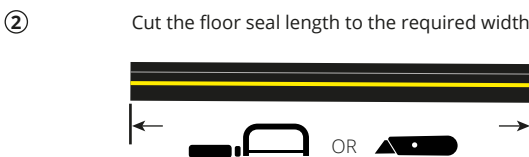
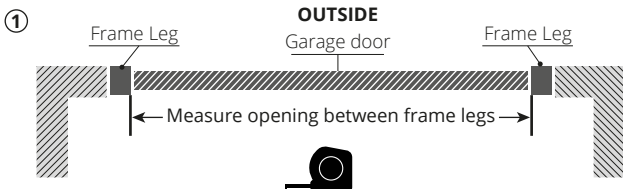

③ With the door closed, position the floor seal so that the raised section is touching the bottom inside edge of the door. (Fig.A)

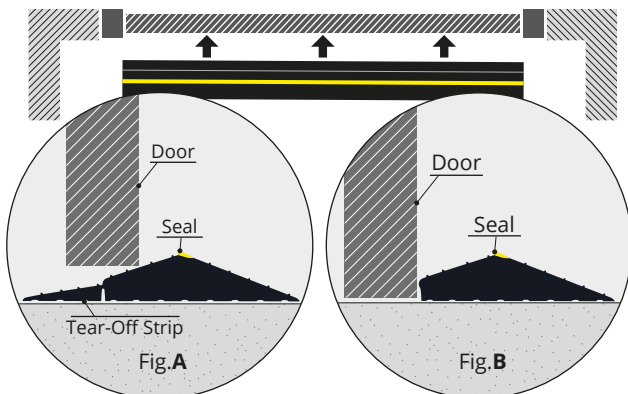

If the gap below the door is too small, tear off the front strip to create a straight edge for the door to close to (Fig.B)

④ Mark along the floor at the back edge of the floor seal using a marker pen.



⑤ Open the door and mark a line along the floor at the front edge of the floor seal using the same marker pen.

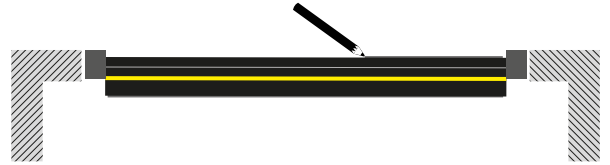

⑥ Remove the floor seal...



⑦ ... and mark two parallel lines roughly 10mm (7/16") inside the lines that you marked on the floor.

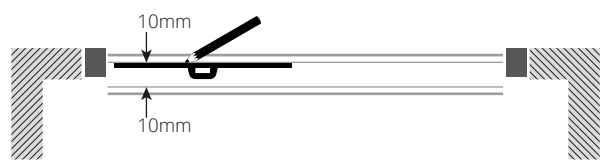

⑧ Apply the adhesive to the two inner parallel lines...

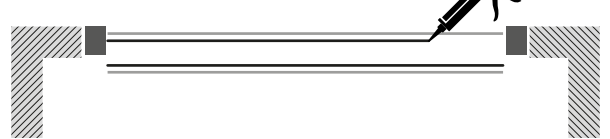

⚠ When using the adhesive we recommend it is applied carefully and use disposable gloves!



⑨ ...then apply the adhesive in a zig-zag formation between the lines at roughly 3" spacing.

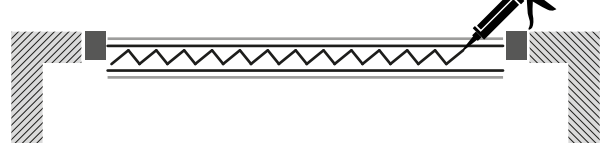

⑩ Finally, starting at one end, place the floor seal over the adhesive on the floor and press firmly downwards.

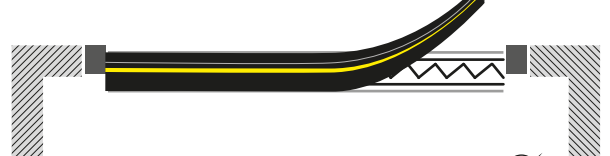

Cut back any exposed adhesive once dry. ✓

⚠ Avoid driving over the seal for 24 hours!



www.weatherdefender.co.uk  
www.garagedoorthresholdseal.com

VIDEO INSTRUCTIONS



## B INSTALLATION BEHIND THE FRAME

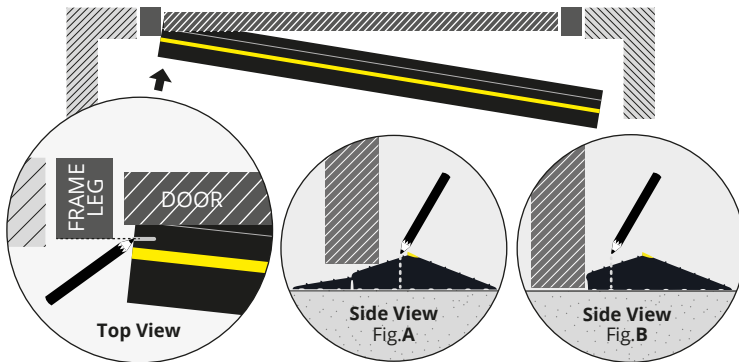
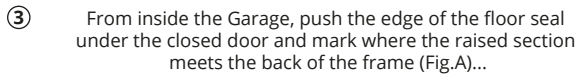
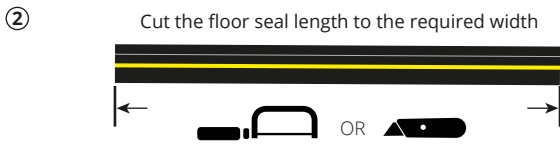
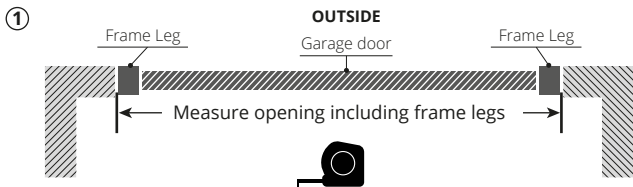

*If the gap below the door is too small, tear off the front strip to create a straight edge for the door to close to (Fig.B).*

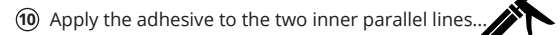
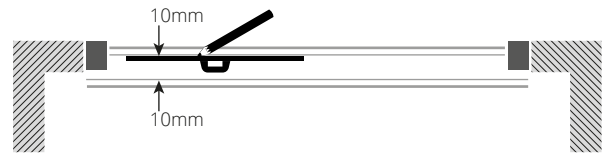
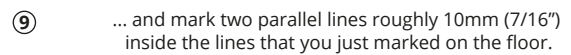
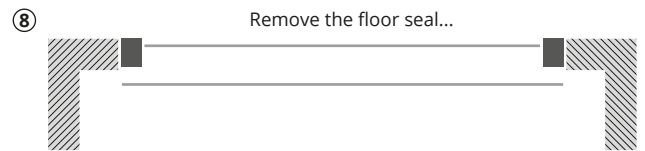
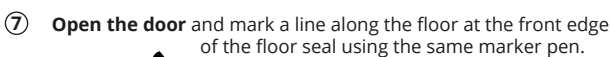
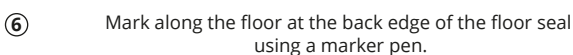
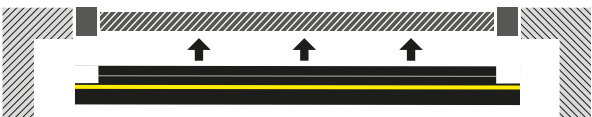
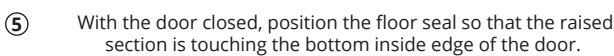
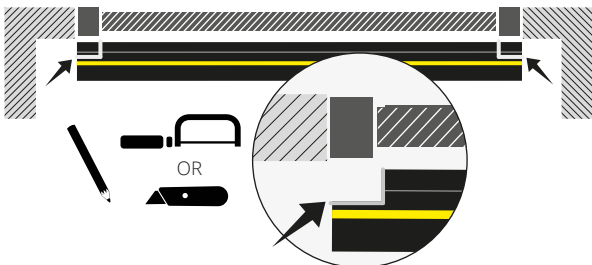
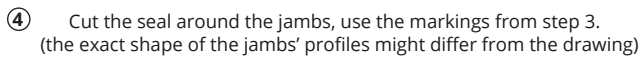

⚠ When using the adhesive we recommend it is applied carefully and use disposable gloves!

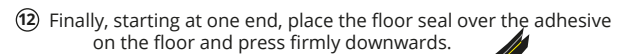
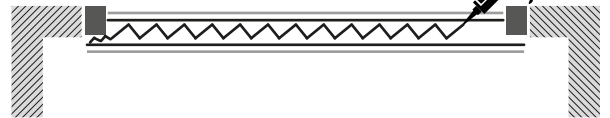
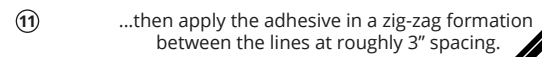

⚠ Avoid driving over the seal for 24 hours!

### Some examples of the many ways Weather Defender is used on different types of doors

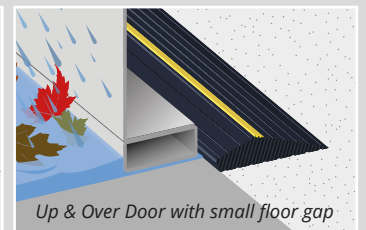
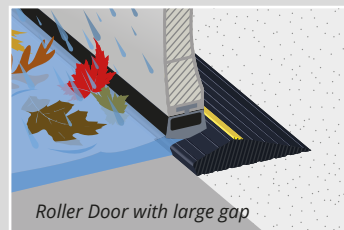
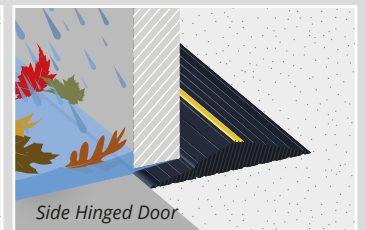

### Adhesive preparation

