

HOW TO PROGRAM AN ADDITIONAL TRANSMITTER

Learning the coding

This function makes it possible to transfer the coding of an already existing hand transmitter to an additional hand transmitter.

1

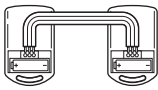

Step 1

Connect both transmitters using the enclosed programming lead.

2

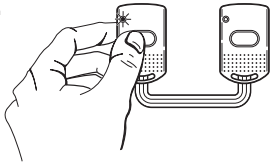

Step 2

Press the button on the existing transmitter and keep it depressed. The LED on transmitter flashes.

3



Step 3

Press the button on the new transmitter whilst keeping the button on the existing transmitter depressed. The LED on the new transmitter flashes rapidly.

4

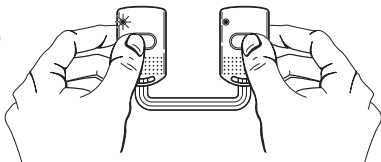

Step 4

After 1 - 2 seconds, the LED on the new transmitter glows constantly. Programming is completed.

Remove the programming lead.

For multi-channel hand transmitters this step has to be carried out separately for each button.

Altering the coding

This function makes it possible to recode the system in the event of losing a hand transmitter.

1

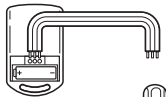

Step 1

Connect the programming lead to the hand transmitter to be recoded.

2

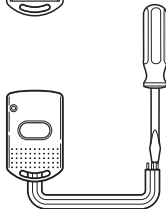

Step 2

Short-circuit one of the two outer wires of the programming lead with the centre wire.

3

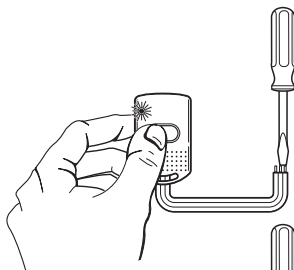

Step 3

Press the button on the hand transmitter for at least 5 seconds. The transmitter establishes a new code for the hand transmitter by means of random programming, during which process the LED flashes rapidly.

For multi-channel hand transmitters this step has to be carried out separately for each button.

4

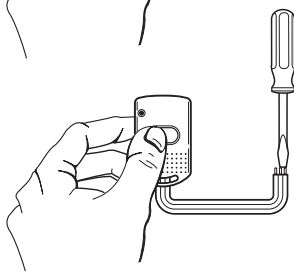

Step 4

As soon as the LED on the hand transmitter glows constantly, the transmitter button can be released and the lead removed. Recoding is completed.

⚠ Attention:

After the hand transmitter has been recoded, the garage door system to be actuated must also be reprogrammed to adopt the new coding, since the old coding has been irretrievably lost (see Fitting Instructions of your garage door opener)!