

## Programming Novoferm Operators

On the motor head, identify the Oval and the two Triangular buttons next to the LCD Display. Correct orientation for viewing, is the triangular buttons to the left of the oval button. These are behind a screen or under a cover, this will need releasing:

- **DC 650 & 800 T, R500 & R700;** Screen drops down on the face of the motor nearest the door. (Figure 1)
- **Novomatic 553, 553S & 553 S III;** The rear clear screen lifts up. (Figure 2)
- **Novomatic 423 & 563S;** There is a rectangular hole at the rear of the motor unit, insert a small screwdriver to release catch that holds the cover, the cover then swings down to reveal the programming buttons. (Figure 3)
- **Novomatic 443 & 573 S;** There are 2 holes in the front corners of the cover, insert a small screwdriver to release catch that holds the cover, the cover then swings down to reveal the programming buttons. (Figure 4)
- **Novoport, Novorol & NR-20;** Open the “oval” button / screen to reveal the programming buttons. (Figure 5)

### Programming Handsets (Novotron 302/502/504/512/522/523/524)

1. Press the **Oval** button on the motor head and the **0** or [ . ] will become a flashing **1**. *(if no. 3 appears you have held the button for too long, do not press anything and the motor will return to standby after 30 seconds)*
2. On the handset, press and hold down the button you want to operate the door, hold down until the flashing **1** becomes a **0**.
3. Repeat for each handset.

### Change Encryption of Handsets, wall switches and Keypads (Novotron 522/524 and Signal 111/217/218)

1. For 522, press and hold the 2 buttons until the red LED stops flashing. For 524, press and hold the 2 middle buttons. Once the flashing has stopped, release the buttons and the red LED will either flash once to signify 64-bit encryption or twice for 128-bit encryption.
2. For 111, press and hold the 2 buttons for 10 seconds. The red LED will flash continuously. Once the flashing has stopped, release the buttons and the red LED will either flash once to signify 64-bit encryption or twice for 128-bit encryption.
3. For 217/218, press and hold No. 1,3 and 0 for 10 seconds. The red LED will flash continuously. Once the flashing has stopped, release the buttons and the red LED will either flash once to signify 64-bit encryption or twice for 128-bit encryption.

### Deleting Only the Handsets & Wireless Devices

1. Turn the unit off at the mains.
2. Press and hold down the **Oval** button on the motor head.
3. Continue to hold down the **Oval** button as the mains electricity is turned on.
4. After two seconds of the power being turned on, release the **Oval** button.
5. The unit will display **0**, if it instead displays a flashing **1**. press the **Oval** button twice to cycle to **0**.
6. Test a previously working handset(s) to ensure deletion.
7. Refer to “Programming Handsets” paragraph.

### Programming the Open and Close Positions (Excluding Novorol)

1. Connect the door to the operator. Ideally not at either the fully open or fully closed position
2. Press and hold the **Oval** button on the motor head for three seconds. When number **3** appears on the LCD display release the button, the **3** will begin to flash.
3. Using the triangular buttons, get the door to the fully open position. Press the **Oval** button on the motor head (to store this position), the flashing **3** will become a flashing **4**.
4. Using the triangular buttons, get the door to the fully closed position (do not over close the door), briefly press the **Oval** button on the motor head (to store this position), the flashing **4** will become a **0**.

5. If instead a **5** displays on the screen, you have entered the special setting. Using the **Oval** button, cycle through until a solid **0** is continuously displayed.
6. The positions are now set, the **Up Triangular** button is now set as an impulse to activate the door in both directions. Tap this once to open the door, then tap the same button again to close it, repeat this cycle once more and the **0** becomes a [ . ] – the force limits are now set.

NB: If the unit has been factory reset, refer to the “Programming Handsets” paragraph.

### Factory Reset

1. Turn the unit off at the mains.
2. Press and hold down the two **Triangular** buttons on the motor head.
3. Continue to hold down the buttons as the mains electricity is turned on.
4. Release when **3** appears and it should be flashing / operator starts to move.
5. The unit will now need reprogramming, refer to step 3 of “Programming Open and Close Positions”.

Accessing programming buttons on:

**Figure 1 - DC 650 & 800 T, R500 & R700**

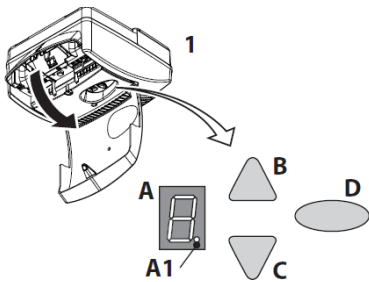

**Figure 2 - Novomatic 553, 553S, 553 S III**

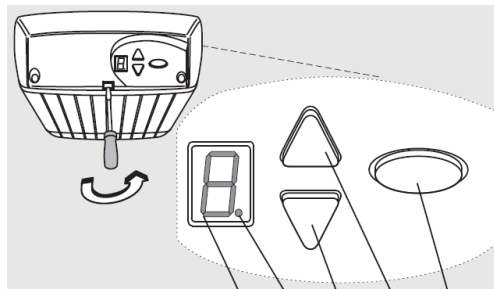

**Figure 3 - Novomatic 423 & 563S**

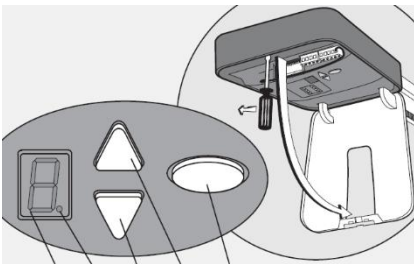

**Figure 4 - Novomatic 443 & 573 S**

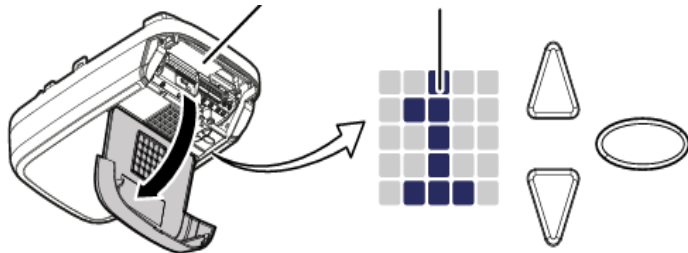

**Figure 5 - Novoport I, II, III, IV, Novorol & NR-20**

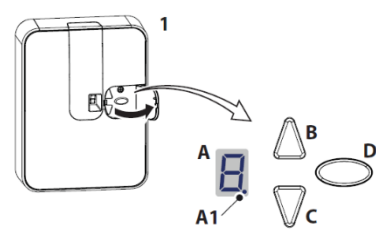
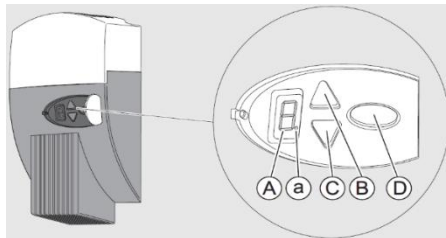
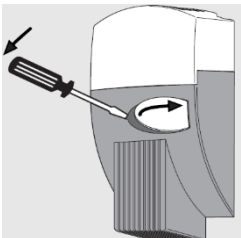

YouTube Video Tutorials